

accommodation

Our 82 ensuite bedrooms give you the comfort and space to work or relax and have been designed to meet the needs of today's business executive. All bedrooms are tastefully furnished and are equipped with desk, direct dial telephone, modem sockets, trouser press, hairdryer, tea and coffee making facilities, radio and satellite TV. Some rooms are wi-fi enabled to give you high speed internet access from your laptop, absolutely free of charge. Superior rooms are particularly spacious and we also offer non-smoking and air conditioned rooms, subject to availability.

dining

From simple working lunches to lavish banquets, our chefs have created an imaginative range of menus to suit every occasion.

The hotel has two restaurants: the elegant Oak Room provides a beautiful setting in which to enjoy lunch and dinner, complemented by fine wines from around the world, whilst the Country Kitchen carvery offers a more relaxed dining experience with homemade soup or hors d'oeuvres to start, a choice of succulent roasts and chef's specials for main course, and a selection of seasonal desserts.

Our day delegate rate includes a working lunch in your meeting room or a three course hot and cold buffet lunch in the Oak Room, whilst the residential rate also includes a table d'hote dinner in the Oak Room or a three course carvery in the Country Kitchen.

Both the Oak Room and the Country Kitchen cater for semi-private dining for parties of up to 25 (minimum numbers may apply), whilst private dining for 10 to 220 guests can be arranged in one of our beautifully appointed rooms.

leisure

After a long day, when it's time to unwind, residential delegates are welcome to enjoy the extensive leisure facilities. There's an indoor heated pool, sauna, steam room and Jacuzzi for relaxing and unwinding and a state of the art air conditioned gym for the more energetic. For the ultimate in relaxation, why not escape to the Spa for an hour or two? Here, experienced therapists offer a range of facial and body treatments, including complementary therapies like Reiki and Indian Head Massage, to leave you revived, refreshed and ready for the next day's business.

extra activities

If you're organising team building events or activities designed to break the ice amongst your delegates we're happy to devise programmes with you. We are within easy reach of the breathtaking rides at Drayton Manor Park and the wonders of chocolate at Cadbury World, and we can organise a wide range of events for you, from a Murder Mystery evening, to paintballing, clay pigeon shooting, skiing on real snow, or a round of golf; all you have to do is ask!

first floor plan

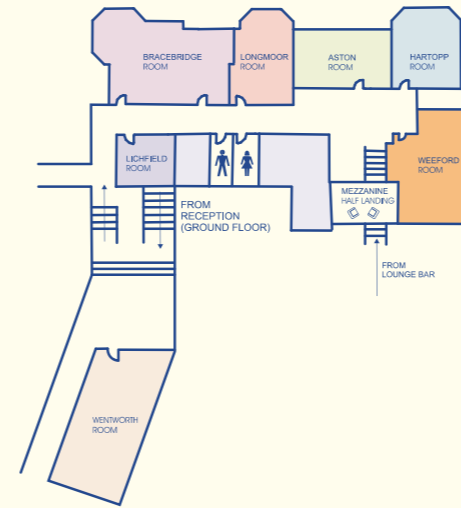

ground floor plan

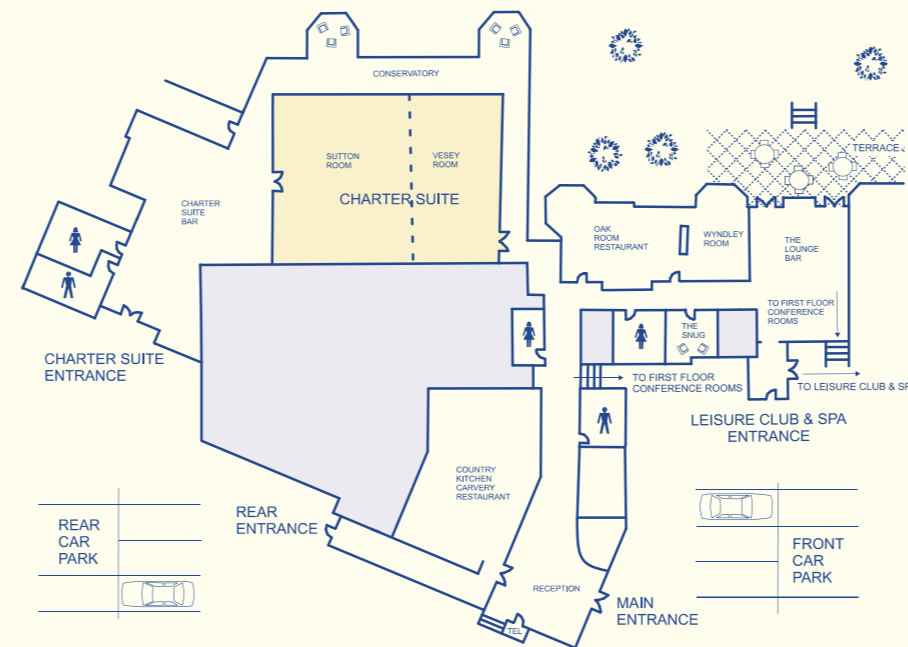

Best Western Premier
MOOR HALL
Hotel & Spa



Moor Hall Drive, Four Oaks, Sutton Coldfield, West Midlands B75 6LN
T: 0121 308 3751 F: 0121 308 8974
E: mail@moorhallhotel.co.uk W: www.moorhallhotel.co.uk



Sister Companies

Best Western The George Hotel, Lichfield
T: 01543 414822
E: mail@thegeorgeichfield.co.uk W: www.thegeorgeichfield.co.uk

Broads Travel Group, Sutton Coldfield
T: 0121 250 2211 (Leisure Travel) T: 0121 323 2233 (Business Travel)
E: holidays@btgj.co.uk W: www.broadstravel.com



Best Western Premier
MOOR HALL
Hotel & Spa



Facilities for Conferences, Meetings and Training Seminars



making business a pleasure.....

Best Western Premier Moor Hall Hotel & Spa is a privately owned four star country house hotel which offers a unique and peaceful setting for conferences, seminars, training sessions and meetings of all kinds.

Set in parkland, the hotel enjoys a prime central location just North of Birmingham and only a few minutes away from the major motorway network, therefore easily accessible for delegates from any part of the country.

The hotel offers the best in conference and meeting facilities; in addition to 8 well equipped meeting rooms, all with natural daylight, we offer 82 ensuite bedrooms, a choice of 2 restaurants and a Leisure Club and Spa with indoor pool and gym. These first class facilities are coupled with a "can do" attitude which goes a long way to ensuring the success of your event, whether a small board meeting or a large product launch. What's more, our dedicated and experienced conference team offer a professional, friendly and flexible approach; from your initial enquiry to your arrival, every tiny detail will be taken care of so you can relax and get down to business.

meeting rooms

Whether your meeting is for 2 or 250 delegates, one of our 8 meeting rooms is sure to suit. All rooms benefit from natural daylight plus free broadband internet access and are equipped with comfortable chairs and stationery boxes; several enjoy splendid views over the surrounding golf course and parkland.

Catering for up to 250 delegates, the Charter Suite is a spacious self contained ground floor room with its own direct entrance from the car park and separate bar and surrounding conservatory for relaxation and refreshment between sessions. This is also a fabulous setting for dinner dances of up to 180 people, with the table centre pieces highlighted by pools of light from overhead spotlights. For extra versatility, the Charter Suite divides into two sections – the Sutton and Vesey – so you can hold your meeting in one room and lunch or dinner in the other.

We are happy to arrange the meeting rooms to your preferred working style, ie; boardroom, U shape, theatre style, classroom or cabaret, and a complete range of professional presentation equipment can be arranged on your behalf.



brief synopsis

	CHARTER SUITE (G)	BRACEBRIDGE (F)	WENTWORTH (F)	WEEFORD (F)	LONGMOOR (F)	HARTOPP (F)	ASTON (F)	LICHFIELD (F)
THEATRE	250	60	50	40	30	20	20	20
CLASSROOM	120	18	14	12	12	10	10	-
BOARDROOM	-	28	24	24	16	14	14	8
U-SHAPE	40	28	20	20	12	12	12	-
CABARET	90	18	18	18	-	-	-	-
BANQUET / PRIVATE DINNER	220	50	30	30	16	12	12	-
RECEPTION / BUFFET (INFORMAL)	250	50	40	30	20	20	20	-
DINNER DANCE	180	-	-	-	-	-	-	-

(G) = Ground Floor

(F) = First Floor

All rooms have natural light and free high speed wi-fi or wired internet access.

The Charter Suite and Wentworth room are air conditioned.

ground floor

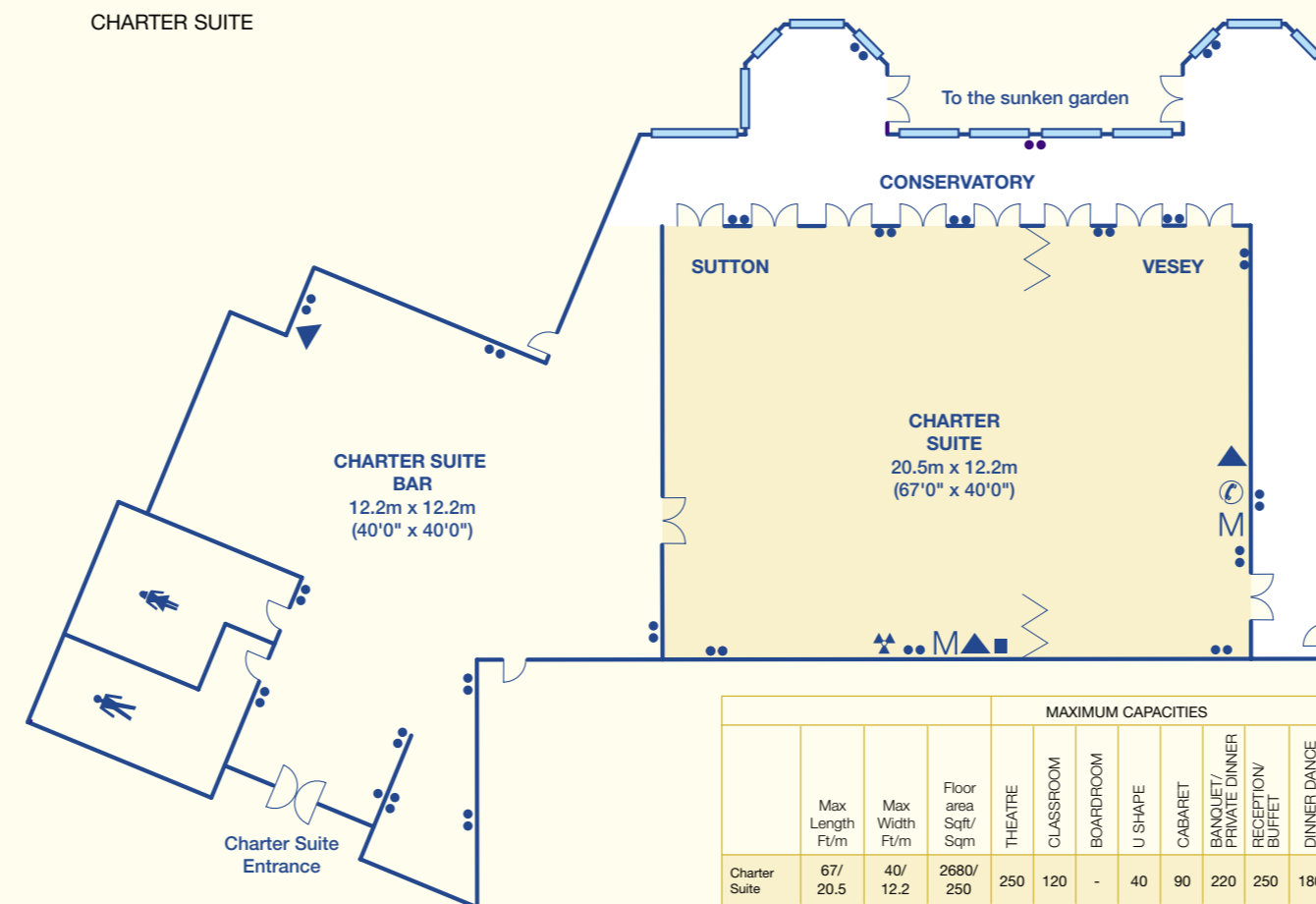

first floor

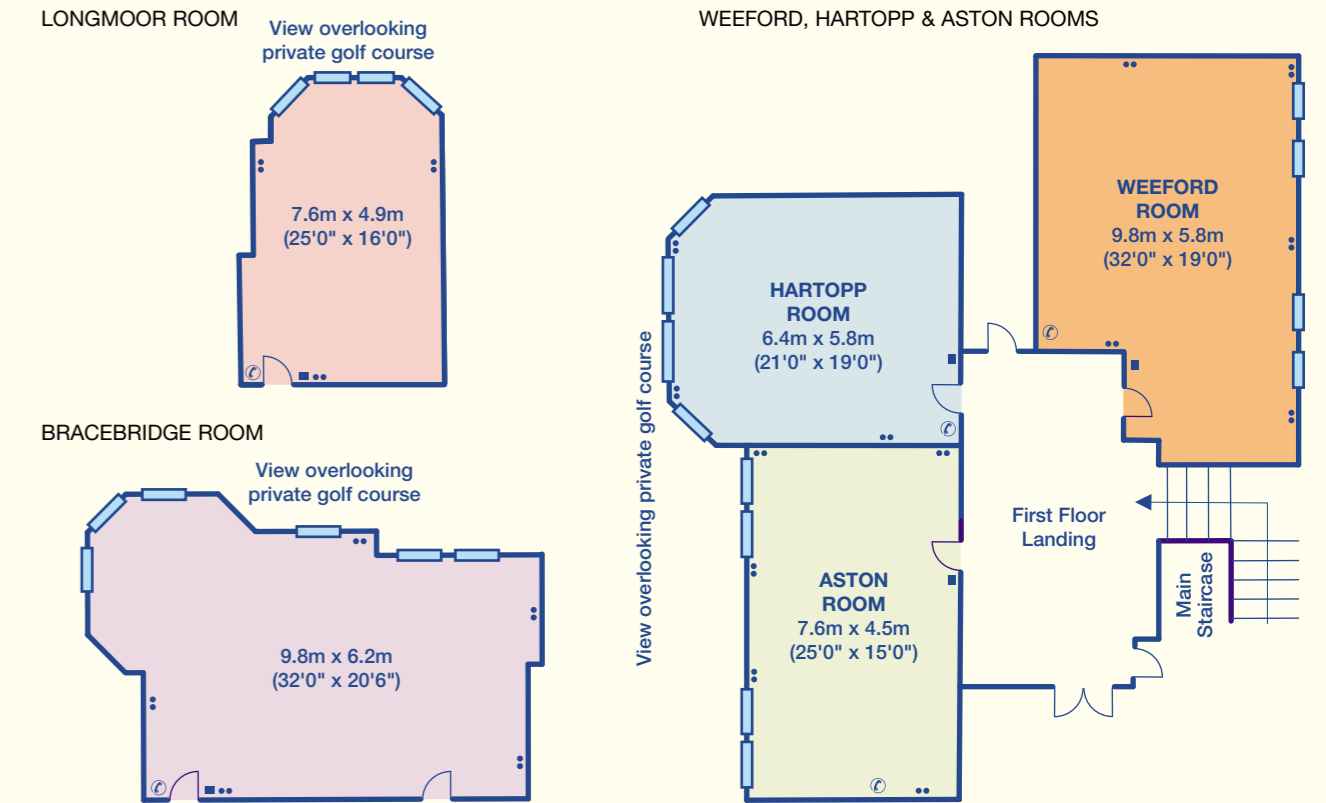

	Max Length Ft/m	Max Width Ft/m	Floor area Sqft/ Sqm	THEATRE	CLASSROOM	BOARDROOM	U SHAPE	CABARET	BANQUET/ PRIVATE DINNER	RECEPTION/ BUFFET
Longmoor	25/ 7.6	16/ 4.9	400/ 37.2	30	12	16	12	-	16	20
Bracebridge	32/ 9.8	20'6/ 6.2	656/ 60.7	60	18	28	28	18	50	50

	Max Length Ft/m	Max Width Ft/m	Floor area Sqft/ Sqm	THEATRE	CLASSROOM	BOARDROOM	U SHAPE	CABARET	BANQUET/ PRIVATE DINNER	RECEPTION/ BUFFET
Weeford	32/ 9.8	19/ 5.8	608/ 56.8	40	12	24	20	18	30	30
Hartopp	21/ 6.4	19/ 5.8	399/ 37	20	10	14	12	-	12	20
Aston	25/ 7.6	15/ 4.5	375/ 34.2	20	10	14	12	-	12	20

WENTWORTH ROOM

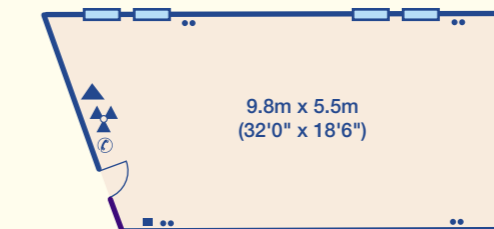

	Max Length Ft/m	Max Width Ft/m	Floor area Sqft/ Sqm	THEATRE	CLASSROOM	BOARDROOM	U SHAPE	CABARET	BANQUET/ PRIVATE DINNER	RECEPTION/ BUFFET
Wentworth	32/ 9.8	18'6/ 5.5	592/ 53.9	50	14	24	20	18	30	40
Lichfield	17/ 5.2	14/ 4.3	238/ 22.3	20	-	8	-	-	-	-

LICHFIELD ROOM

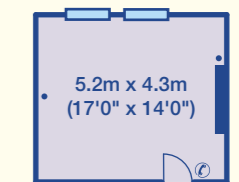

key

- Full Height Folding Screen
- Window
- 13 AMP Single Socket
- 13 AMP Double Socket
- Lighting Control Dimmer
- Microphone Plug
- TV Aerial
- Telephone Plug
- Air Conditioning