

Country Style Painted Kitchen Base & Larder Units

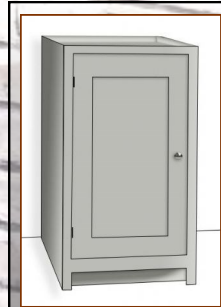

1 Door Base Units

300mm **£269**
400mm **£269**
500mm **£299**
600mm **£299**

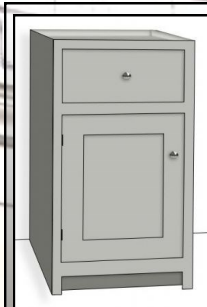

1 Door / Drawer Base Units

300mm **£289**
400mm **£289**
500mm **£329**
600mm **£329**



3 Drawer Base Units

300mm **£299**
400mm **£299**
500mm **£339**
600mm **£339**



Ascending Drawer Base Units (Painted)

500mm **£369**
600mm **£369**

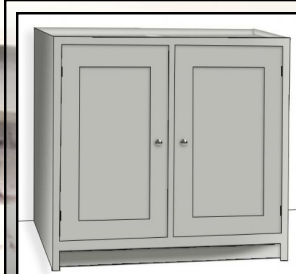

2 door Base Units

800mm **£379**
1000mm **£389**



2 Door / 2 Drawer Base Units

800mm **£399**
1000mm **£429**

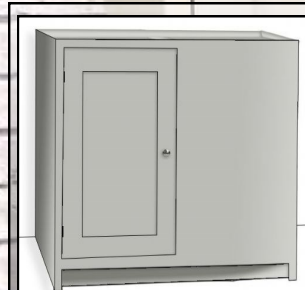

Corner Return Base Units

1000mm
£349

*Left or right
handed*



Belfast Base Units

480mm **£249**
600mm **£269**
800mm **£339**

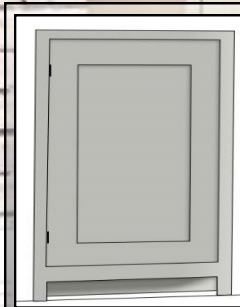

Integrated Doors

450mm **£99**
600mm **£119**

Fully Assembled Cabinets

Bespoke Sizes Available

Hand Made



2 Door Larder Units

500mm **£559**
600mm **£569**



Double Oven Larder Units (painted)

600mm **£539**



Oven & Microwave (painted)

600mm **£539**



Cooker Base Unit

600mm **£249**



**MADE IN
ENGLAND**



Country Style Painted Kitchen Wall, Utility & Over Mantle Units



**MADE IN
ENGLAND**



1 Door Wall Units

300mm **£259**
400mm **£259**
500mm **£269**
600mm **£269**



2 Door Wall Units

800mm **£339**
1000mm **£349**



Corner Return Wall Unit

600mm
£299

Fully Assembled

**Wall units available with glazed doors
for an additional cost of £25 per door.**

Bespoke Sizes Available



Utility Fitments (painted)

192cm wide x 650mm deep
Includes sink, Oak worktop & Taps for
£1039



Utility Fitments (painted)

192cm wide x 650mm deep
Includes sink, Oak worktop,
Taps & Covering doors for **£1279**



Over Mantle Units **£1079**

1220mm high, 300mm wide towers
with an opening gap of 1100mm

Can be made to Bespoke sizes





Cabinet Details

Cabinet Construction

- All cabinets are made from 18mm pine and are solid throughout.
- All drawer boxes are 18mm thick and the drawer bases are 9mm thick tongue & groove section.
- The backs of the cabinets are 9mm thick tongue & groove section.
 - Each cabinet is supplied with 1 adjustable shelf.
- Base cabinets have a 70mm void at the back to aid plumbing e.t.c.
 - All doors are 21mm Thickness
 - All Cabinets are fully assembled

Because we manufacture all units from start to finish
we are able to offer Bespoke sizes on any cabinets

Standard paint colours are White, Cream or Pavilion grey

Any Farrow & ball colour can be done for an additional £49 (up to 6 units)

